

BUILDING A BRIGHTER FUTURE FOR ABINGTON MIDDLE SCHOOL



HOW EDUCATION WILL CHANGE IN A NEW MIDDLE SCHOOL



Classroom Improvements

- **Instructional spaces built around the 4Cs of education:** collaboration, communication, creativity and critical thinking, such as large-group instructional spaces for joint-classroom projects, and rooms designed with the proper space, seating and technology for student presentations.
- **Improvements to the classroom environment** so students can better focus on instruction, such as more consistent temperature controls.
- **Small group rooms to offer pull-out services for students** who need additional educational and emotional support, such as students with IEPs or 504s.
- **Ensuring all classrooms are ADA accessible.**
- **Outfitting the building with modern electric and technological equipment** to enhance existing courses and adapt to emerging technologies.
- **Flexible classroom layouts and furniture** so teachers can tailor their classrooms to their subject and method of delivery, in addition to providing the ability for small group projects and discussions in the classroom.
- **Exterior-facing windows versus windows that face hallways** to reduce distractions and noise, in addition to improving the flow of light.
- **Ensuring all science classrooms are upgraded and enlarged** so that students can engage in more hands-on learning and laboratory experiments.
- **Replacing the 1960s shop classrooms** that were converted into robotics rooms with state-of-the-art STEM labs that are intentionally designed with built-in technology.
- **Additional space for art, family consumer science and music rooms** that are outfitted with modern equipment.
- **A modern, intentionally designed production studio** with updated technology that can also be used for video production and multimedia tech courses.

If approved by voters on May 20, the final design for the new Abington Middle School will be created with input from teachers, parents/guardians, students and residents to ensure these goals are achieved.



OneASDOneFuture.org

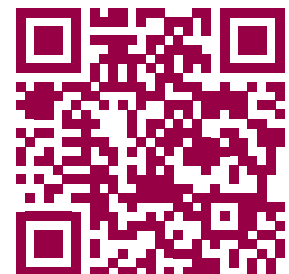

HOW EDUCATION WILL CHANGE IN A NEW MIDDLE SCHOOL



Common Area Improvements

- **Designing “school within a school” areas** that focus on specific grades or subject matters, such as wings organized by grade level to support personalized learning and belonging.
- **More appropriately sized performing arts spaces** for instructional use and after-school activities, with updated A/V equipment.
- **Ability to enhance guest speaker programming and opportunities** through expanded assembly spaces so that all students in a grade can attend at the same time, establishing a stronger sense of community.
- **Larger, flexible and more effective physical education spaces** with varied activities that are not limited by space constraints, which would also provide more opportunities for after-school activities that give students structure and improve school culture.
- **Redesign of counseling center and health offices** to create a more welcoming atmosphere for students when they need support most, and are in need of more privacy.
- **Redesign of common spaces**, including hallways and stairwells that allow for better management of student behaviors, which benefits school climate for students, teachers and staff.
- **Locker rows** designed not only for better traffic flow, but sized and shaped for the materials students are storing today versus in the 1960s.
- **Improved traffic flow throughout the building** to reduce passing time and student tardiness.
- **New bathrooms that are ADA compliant** and more appropriately located/sized for the

student population so that less class time is missed for bathroom breaks.

- **Modern food-prep and cafeteria spaces** for more fluid and accessible service.
- **Providing teachers with the space needed** to work with other staff on curriculum planning and student assessment.

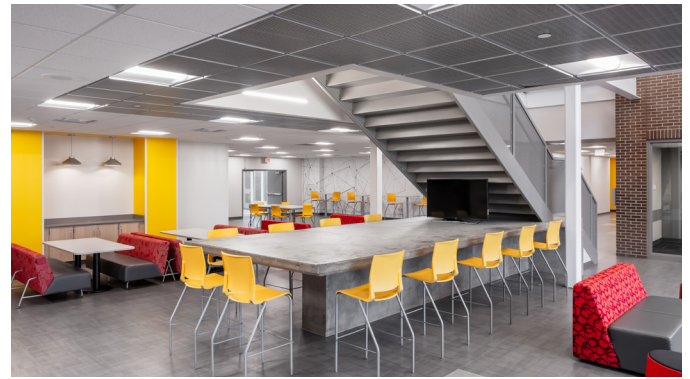

These photos are examples and are not intended to show complete design images or renderings. If funding is approved, the design process would involve community input to ensure the design best reflects those who would use the facility.

Prepared and paid for by Abington School District, 970 Highland Avenue, Abington, PA, 19001, for informational purposes. This publication is not prepared on behalf of any candidate, or in favor of/opposition to any ballot question.